

**GENERAL NOTES:**

C.L.L. - CONTRACT LIMIT LINE  
N.I.C. - NOT IN CONTRACT

1. THE SEQUENCE OF IMPORTED SOIL PLACEMENT AND TREE PLANTING SHALL PROCEED FROM SOUTH TO NORTH IN ORDER THAT THE COMPACTION CRITERIA OF SOILS, ESPECIALLY AROUND ROOT ZONES, NOT BE EXCEEDED.

2. CONTRACTOR IS EXPRESSLY REQUIRED TO PREPARE THE MINIMUM HEIGHT OF STABLE FILL FOR THE PURPOSES OF MAINTAINING WALL STABILITY DURING TREE AND IRRIGATION RELATED OPERATIONS. TAKE MEASURES TO PREVENT THE SLOPED FILL FROM WEATHER CONDITIONS, AND ANY OTHER MEASURES THAT MAY BE NECESSARY TO PREVENT WALL DEFLECTION. SHOULD THE CONTRACTOR REQUIRE THAT THIS SLOPE BE OBTAINED IN ISOLATED AREAS ONLY, OR IN SEQUENTIAL OPERATIONS ONLY, SUBMIT A SHOP DRAWING SHOWING THE PROPOSED DISTANCE AND OBTAIN APPROVAL BEFORE PROCEEDING. (SEE 02.03)(L1.02)

3. NOT SHOWN ON THESE DRAWINGS ARE LIGHTING AND WIRELESS DATA INSTALLATIONS, FOR WHICH BOTH FUTURES AND CONDUIT PLACEMENT ARE LIKELY TO CONFLICT WITH PLANTING LOCATIONS AND TIMING. THE CONTRACTOR SHALL ACCOMMODATE AND COORDINATE OPERATIONS WITH THE WORK OF OTHERS, INCLUDING THE FINISHING OF GRADE SURFACES IN THE VICINITY OF THESE INSTALLATIONS.

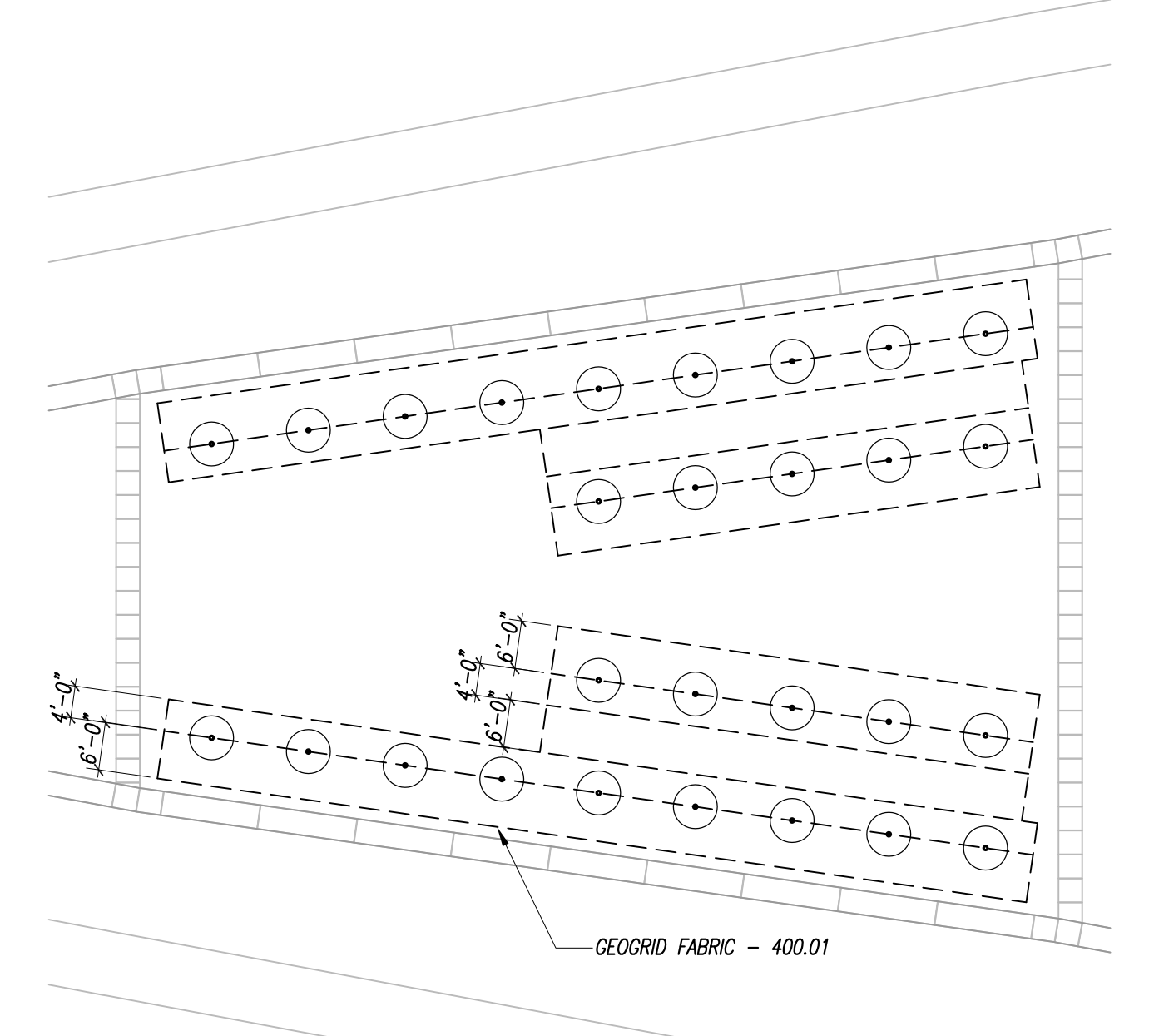

02 FORECOURT GEOGRID PLAN  
SCALE: 1" = 20'-0"

**NUMBERED TILIA CORDATA TREE (LITTLE LEAF LINDEN)  
AT THE HALKA NURSERIES**

Millstone Twp.	Southern NJ	Totals:
Seal #	Tree Caliper (inches)	Cal. Quantity
1	6	19
2	6	22
3	6	23
4	6	24
5	6	33
6	6	34
7	6	35
8	6	36
9	5 1/2	37
10	6	38
11	6	39
12	5 1/2	40
13	5	51
14	5 1/2	52
15	5 1/2	53
16	5 1/2	54
17	6	55
18	6	56
19	6	57
20	6 1/2	58
21	6	59
22	6	60
23	6	61
24	6 1/2	62
25	6	63
26	6	64
27	6	65
28	6	66
29	6	67
30	5 1/2	68
31	6	69
32	6	70
33	5	71
34	5 1/2	72
35	5	73
36	5 1/2	74
37	5 1/2	75
38	5 1/2	76
39	6	77
40	6	78
41	6	79
42	6	80
43	5 1/2	81
44	5 1/2	82
45	5 1/2	83
46	5 1/2	84
47	6	85
48	6	86
49	6	87
50	6	88
51	6	89
52	6	90
53	6	91
54	6	92
55	6	93
56	6	94
57	6	95
58	6	96
59	6	97
60	6	98
61	6	99
62	6	100
63	6	101
64	6	102
65	6	103
66	6	104
67	6	105
68	6	106
69	6	107
70	6	108
71	6	109
72	6	110
73	6	111
74	6	112
75	6	113
76	6	114
77	6	115
78	6	116

**NUMBERED FAGUS SYLVARTICA VAR. RIVERSII TREES (RIVERSII BEECH)  
AT THE WHITMORE NURSERIES**

COPPER BEECH TREES ARE 13"-14" CALI PER

- INDICATES AREA OF TURF SOIL (200.04)
- INDICATES AREA OF HORTICULTURAL SOIL (200.01) + TURF SOIL (200.04)
- INDICATES AREA OF LINDEN TREE SOIL (200.02)
- INDICATES AREA OF HORTICULTURAL SOIL (200.01)
- INDICATES AREA OF HORTICULTURAL SOIL (200.01) + PLANTING BED SOIL (200.03)

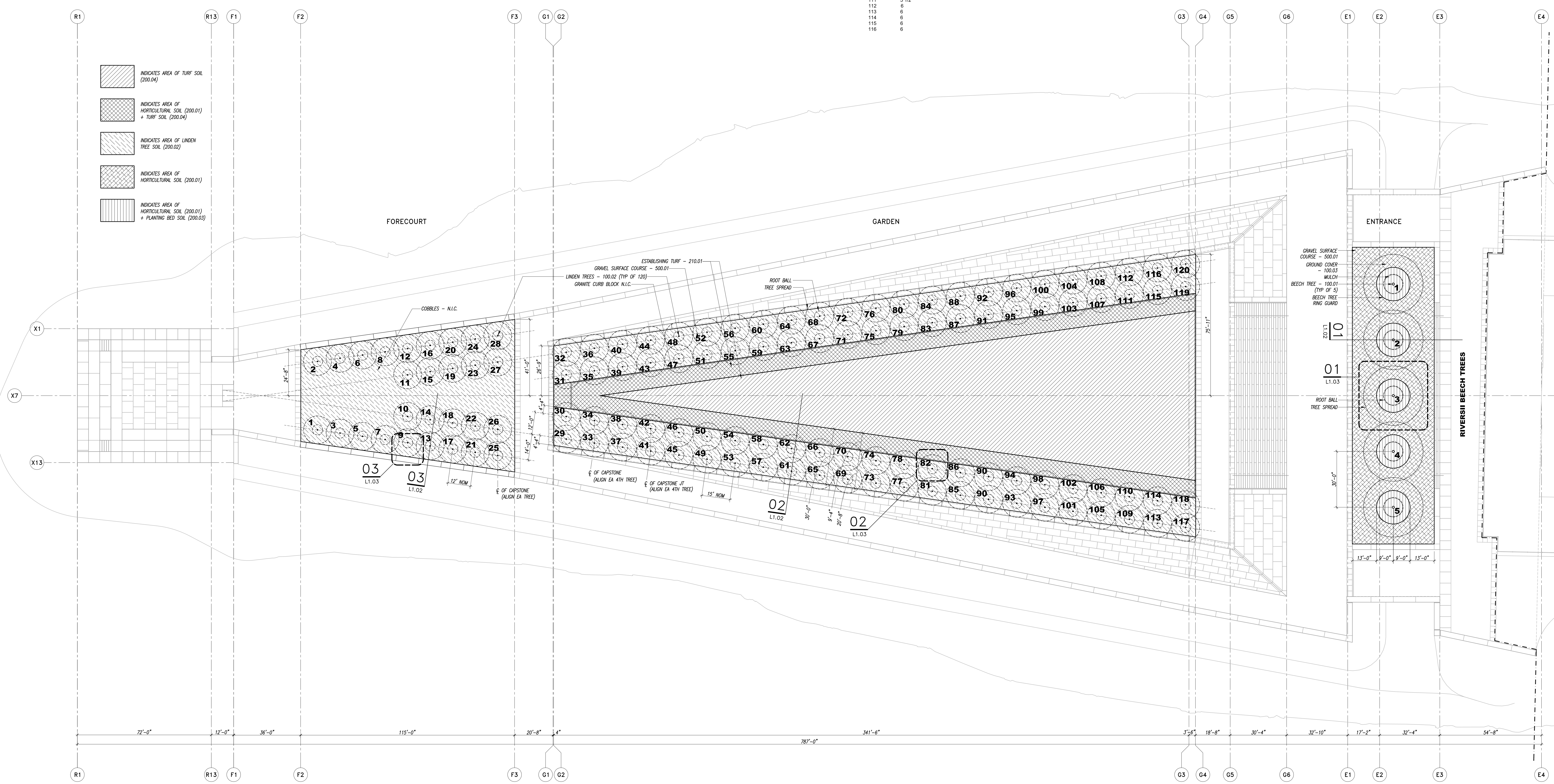

01 LANDSCAPE PLAN  
SCALE: 1" = 20'-0"

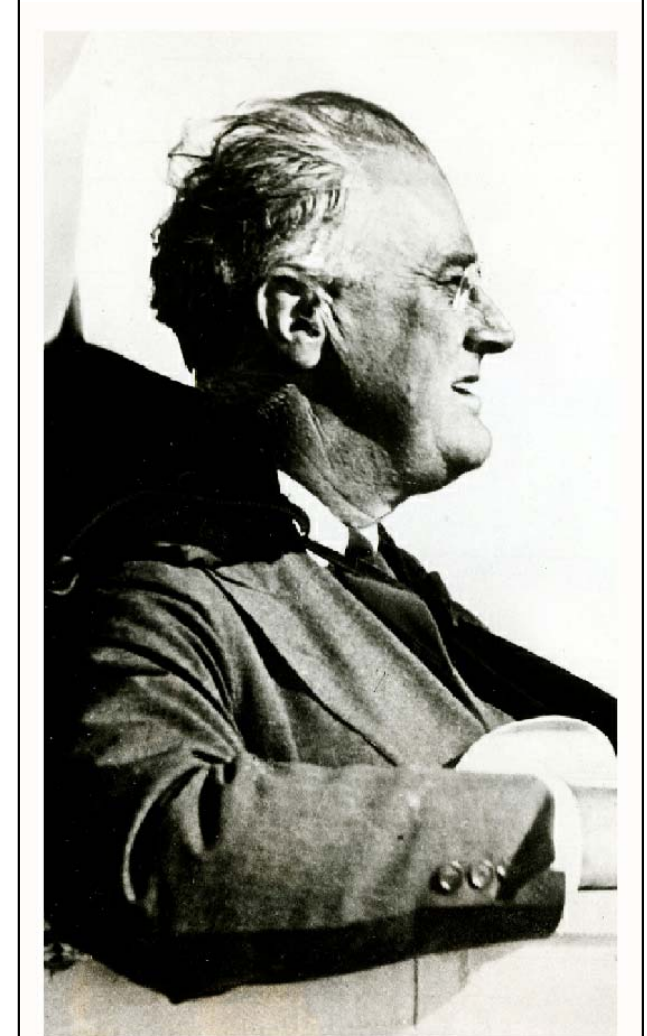

FRANKLIN D. ROOSEVELT  
**FOUR FREEDOMS PARK**

CONCEPT AND DESIGN BY  
LOUIS I. KAHN, FAIA (1901-1974)

Architect of Record:  
MITCHELL/GIURGOLA ARCHITECTS, LLP  
630 NINTH AVENUE, SUITE 711  
NEW YORK, NY 10025

Geotechnical & Civil Engineer:  
LANGAN ENGINEERING &  
ENVIRONMENTAL SERVICES  
RIVER DRIVE CENTER 1  
ELMWOOD PARK, NJ 07407

Structural Engineer:  
WEIDINGER ASSOCIATES INC.  
375 HUDSON STREET  
NEW YORK, NY 10014

MEP Engineer:  
JOSEPH R. LORING  
AND ASSOCIATES, INC.  
21 PENN PLAZA, 14TH FLOOR  
360 WEST 31ST STREET  
NEW YORK, NY 10001

Landscape Architect:  
LUIS VILLAV LOIS SHERR ASSOCIATED  
870 UN PLAZA  
NEW YORK, NY 10017

Sponsoring Agency:  
ROOSEVELT ISLAND OPERATING  
CORPORATION (RIOC)  
581 MAIN STREET  
NEW YORK, NY 10044

Copyright © 2008, Mitchell/Giurgola Architects  
All dimensions and existing conditions shall  
be checked & verified by the contractor before  
proceeding with the work.

ISSUE FOR BID

REVISIONS

No.	Date	Comments
1	01.03.12	REVISED TO SHOW TREE DESIGNATION

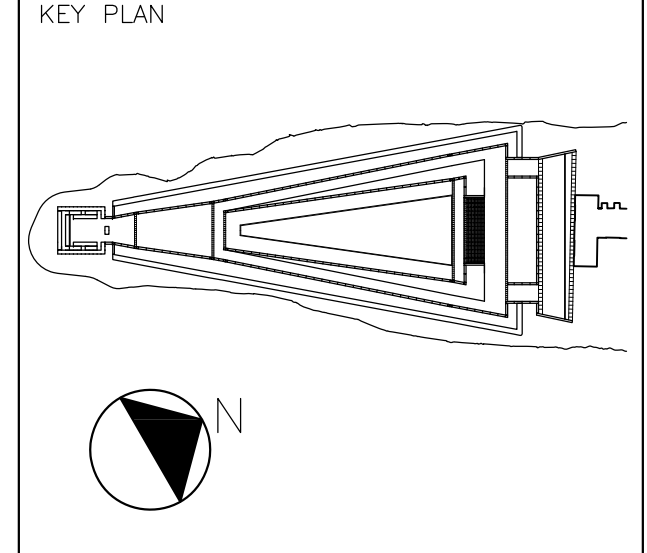

Project:  
**FRANKLIN D. ROOSEVELT FOUR FREEDOMS PARK**

Drawing Title:  
**LANDSCAPE PLANS**

PROJECT NO: 071209 SCALE: 1" = 20'-0"  
TRADE: DATE: 09-15-2011

L1.01